



Rcstars All-In-one PC adopts Intel core processors, and streams an entire screen system into an elegant, powerful device with the ability to create, stream and share HD Content, you can work and play with more confidence, All in one is well suited for both touch and non touch applications. Featuring a unique quick disconnect PC design, multiple I/O Ports, makes the most of your digital world. All in one touch screen computers could be used in a wide range markets, such as gaming machines, hospitality systems, industrial automation, interactive kiosks, point of sale system and retail displays.

Key Features:

CPU: Intel® Core® Processor, I5 5200U
(Dual core four thread, 3M L3 Cache, 2.7GHz)
Chipset: Haswell-U
Graphic Card: Intel HD5500
Memory: 4GB RAM, 120G SSD
Audio: Realtek ALC662
Ethernet LAN: 1*RTL8111F LAN

Application:

Security
Transportation
Atm Automation
Medical Equipment
Gaming Machine
Networking Pos
General Application

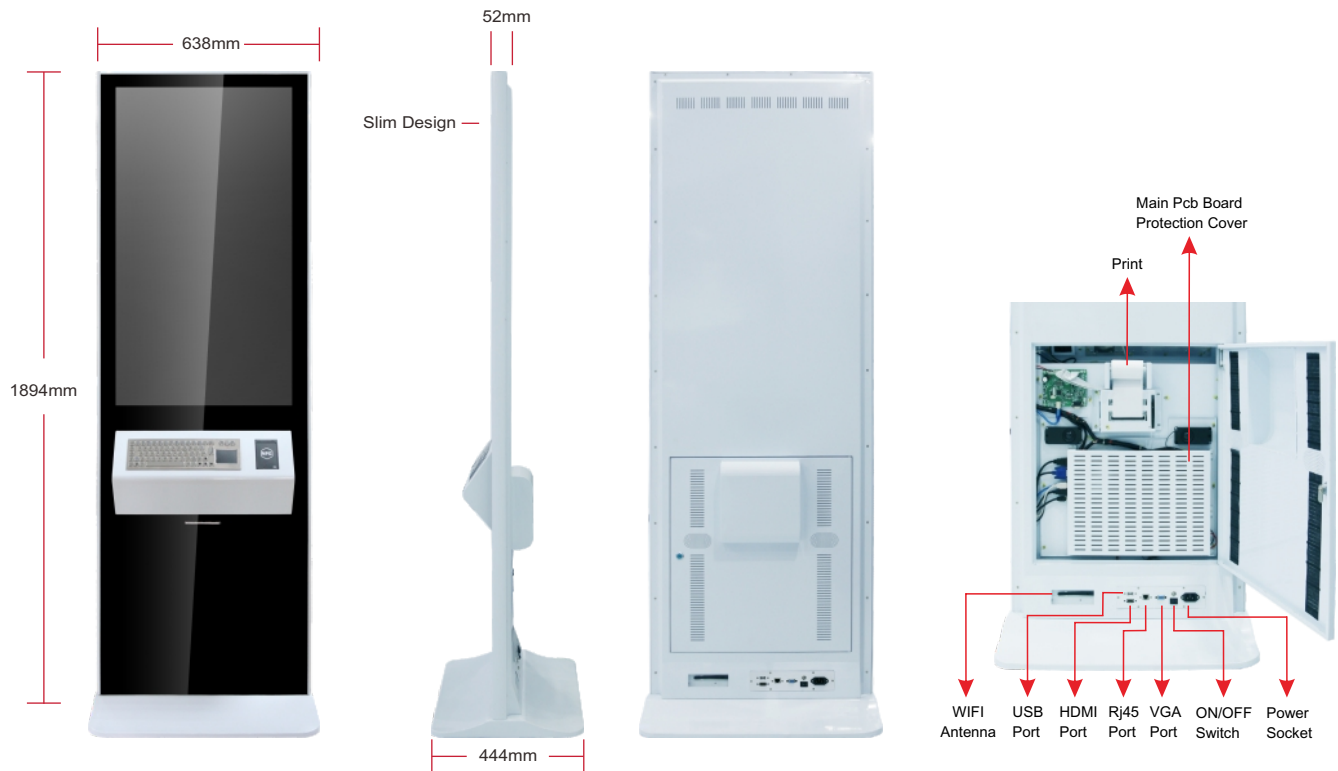

Specifications

PANEL	Panel Model	43inch TFT LED	RESOLUTION REFRESH RATE	Output Mode	1920 x 1200 60Hz
	Max Resolution	1920x1080		1920 x 1080 60Hz	
	Aspect Ratio	16:09		1600 x 1200 60Hz	
	Pixel Pitch	0.4903x0.4903		1440 x 900 60Hz	
	Viewing Angle	89/89/89/89		1366 x 768 60Hz	
	Contrast Ratio	1200:1		1360 x 768 60Hz	
	Brightness	500cd/m ²		1280 x 1024 60Hz	
	Response Time	26ms		1280 x 800 60Hz	
	Display Area (mm)	941.184x592.416mm		1280 x 768 60Hz	
	Panel Size(mm)	973x565.8x29mm		1024 x 768 60Hz	
	Screen Weight	11Kg		800 x 600 56, 60, 72, 75Hz	
	Lamp Type	WLED		640 x 480 60, 67, 72, 75Hz	
CELERON SPECIFICATION	CPU	Intel® Core® Processor, I5 5200U (Dual core four thread, 3M L3 Cache, 2.7GHz)	TOUCH	P-CAP Touch / infrared Touch (optional)	
	Chipset	Haswell-U	PRINT	EPSON M-T532	
	Bios	Intel HD5500	POWER	Mains Power Consumption	AC 100-240V, 50-60 Hz 85 W
	Memory	4GB RAM, 120G SSD	SOUND	Built-in Speakers	2 x 10W
	Audio	Realtek ALC662	DIMENSION & WEIGHT	Machine Size	1894x52x638mm 645x50x444mm(stand base)
	Ethernet LAN	1*RTL8111F LAN		Machine Weight	71KG / 12.5KG(stand base)
CONNECTOR	Rear Panel I/O	X1 HDMI port X1 VGA port X1 RJ-45 port X2 USB 2.0 ports and 2 * USB 3.0 ports X2 Audio I/O ports (Mic and Line-out)		Carton Size	2010x400x755mm
CONNECTIVITY	LAN	RJ45 Port, 10/100M Ethernet		Carton Weight	98KG
	WiFi	Built-in WiFi 802.11B/G/N		Wooden Case Size	2040x430x935mm (1PCS)
	3G (Optional)	WCDMA	OTHER	Regulatory Approvals	CE, FCC, ROHS
MULTIMEDIA	USB Playback Audio	AAC, AIF, AIFF, ASF, LPCM, M3U, M4A, MP3, MP4, WAV, WMA		Warranty	1 year warranty
	USB Playback Picture	BMP, GIF, JPEG, JPG	ACCESSORIES	Included	AC Power Cord, CD, Tools and Screws, User manual, Keys
	USB Playback Video	M2TS, M4V, MK3D, MKV, MP4, MPEG, MPG, MTS, TS, TTS, VOB, WMV			